



SURVEYOR'S OFFICE
Hamilton County

Kenton C. Ward, Surveyor

Suite 146

776-8495

One Hamilton County Square

Noblesville, Indiana 46060-2230

May 19, 1994

TO: Hamilton County Drainage Board

RE: E.M. Osborn Drain

Attached is a drain map and drainage shed map for the E. M. Osborn Drain. At this time the drain is number nine (#9) on the 1994 Classification List. I would recommend that the drain be placed on a maintenance program at this time.

This drain was constructed in 1920 through petition to the Hamilton County Circuit Court. The drain consisted of a main ditch and four (4) arms totaling 12,027 feet and was constructed at a cost of \$6,956.48. The drain was repaired in 1955. This repair consisted of tile replacement at a cost of \$2,090.00.

In 1981 a portion of Arm #1 was relocated around the proposed aircraft hangers, which was to be an expansion of Westfield Air port. This work was done at the property owner expense and replaced approximately 450 feet of tile with 1307 feet of tile. The length of the drain as it exists today is 12,884 feet.

At this time the drain should be placed on a maintenance program which maintenance work required is as follows:

- A. Repair of tile outlet as might be required;
- B. Repair of existing tile outlet at drain end;
- C. Replacement of broken tile;
- D. Removal of debris and/or blockages from existing tile drain;
- E. Installation of breather pipes as might be required;
- F. Cleaning and/or repair of existing catch basins as might be required;
- G. Any other repairs necessary to restore drain to its original intended condition and use.

The frequency with which maintenance work should be performed is annually as required by the condition of the drain. Immediate repair will include five (5) tile holes and some cleaning of the open ditch in order to unobstruct the outlet. The estimate for this work is as follows:

100' Open Ditch	\$ 750.00
Tile Repair	\$ 2558.00

Total	\$ 3308.00

This proposal does not involve additional length or arms for the drain. Except for the 1981 relocation the drain is unchanged from its 1920 description.

Upon review of the proposed project I do not believe any damages will result to land owners by this project. Therefore, damages for each tract shall be set at \$0.00.

The drainage shed for this drain consists of 556.71 acres. I have reviewed the drainage shed for the proposed maintenance program and upon considering each parcel individually, I believe that each parcel will have equal benefits as provided by the drain. I

recommend the Board assess each tract \$5.00 per acre with a minimum assessment of \$25.00 per tract. The annual maintenance collection will be \$3,311.54.

I recommend the Board set a hearing for this matter in July 1994.

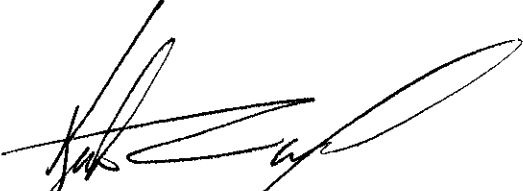

Kenton C. Ward
Hamilton County Surveyor

KCW/jk

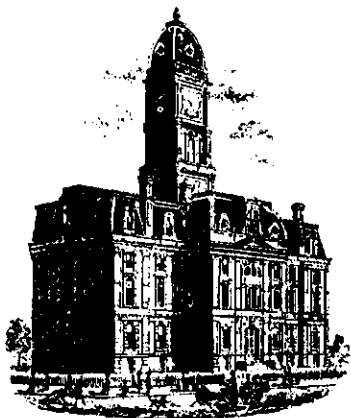

SURVEYOR'S OFFICE
Hamilton County

Kenton C. Ward, Surveyor

Suite 146

776-8495

One Hamilton County Square

Noblesville, Indiana 46060-2230

August 28, 1995

TO: Hamilton County Drainage Board

RE: E.M. Osborne Drain

Attached is a petition and plans for the proposed relocation of the E.M. Osborne Drain. The relocation is being proposed by Fabcon, INC. The proposal is to intercept the regulated drain at the north property line of Fabcon, INC., approximately STA 7+90 of the original description, and run a new line 310 feet south, 255 feet east, 1300 feet south, 370 feet east and 20 feet southeast connecting back into the Osborne Drain at the east line of Fabcon at the North R/W of ST. Rd. 32, approximately STA 26+80 of the original description. This line will consist of 970 feet of 10" concrete tile; 1285 feet of 12" RCP and 5 manhole structures. The total length of new tile shall be 2255 feet. The 1890 feet of original drain between STA 7+90 and STA 26+80 shall be vacated. This proposal will add an additional 365 feet to the drains length.

The cost of the relocation is to be paid by Fabcon, Inc. Because the project is to be paid by the petitioner and is within the boundaries of the petitioners property the project falls under the requirements as set out in IC 36-9-27-52.5. Therefore, a hearing is not required for the petition. I recommend approval by the Board at this time.

Sincerely,

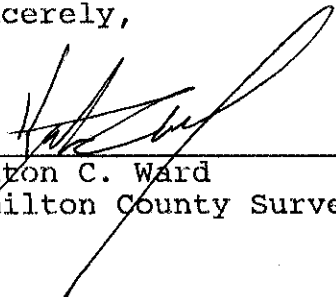
Kenton C. Ward
Hamilton County Surveyor

KCW/nw

Hamilton County Drainage Board
Court House
Noblesville, Indiana

IN RE: Edmund E.M. Osborne Drain
Hamilton County, Indiana

PETITION FOR RELOCATION AND RECONSTRUCTION

Fabcon LLC

(hereinafter "Petitioner"),

hereby petitions the Hamilton County Drainage Board for authority to relocate and improve a section of the E.M. Osborne Drain, and in support of said petition advises the Board that:

1. Petitioner owns real estate through which a portion of the E.M. Osborne Drain runs.
2. Petitioner plans to develop its real estate with roads, buildings, utilities, storm drains, sanitary sewers and other structures.
3. Petitioner's proposed development of its real estate will require relocation and reconstruction of a portion of the E.M. Osborne Drain, as specifically shown on engineering plans and specifications filed with the Hamilton County Surveyor.
4. The work necessary for the proposed relocation and reconstruction will be undertaken at the sole expense of the Petitioner and such work will result in substantial improvement to the E.M. Osborne Drain, without cost to other property owners on the watershed of the E.M. Osborne Drain.

WHEREFORE, Petitioner requests that an Order issue from the Hamilton County Drainage Board authorizing relocation and reconstruction of the E. M. Osborne Drain, in conformance with applicable law and plans and specifications on file with the Hamilton County Surveyor.

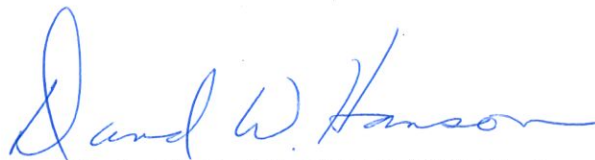

Signed

David W. Hanson

Printed Name

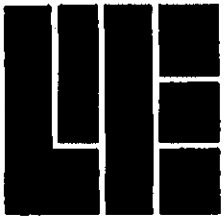

WEIHE ENGINEERS, INC.

Civil Engineers

Land Surveyors

Land Planners

ALLAN H. WEIHE, P.E., L.S.
PRESIDENT

MICHAEL L. DEBOY, L.S.
VICE PRESIDENT

Engineers Estimate for the Relocation of the Edmund M.
Osborne Drain.

10" Concrete Field Tile	\$9375.00
12" RCP	\$12312.50
Inlets	\$5750.00
TOTAL	\$27437.50

Allan H. Weihe
dated July 18, 1995

Post-It™ brand fax transmittal memo 7671		# of pages >	
To	<i>Kent Ward</i>	From	<i>Alan</i>
Co.		Co.	
Dept.		Phone #	
Fax #	<i>776-9628</i>	Fax #	

CERTIFICATE OF COMPLETION AND COMPLIANCE

TO: HAMILTON COUNTY SURVEYOR

RE: Part of Section 35-T19-R3E, Osborne Legal Drain Reroute
Fabcon, Incorporated located near N.E. Corner S.R. 32 & Springmil

W.E.I. Job No. 95-312
I hereby certify that:

- 1.) I am a Registered Land Surveyor in the State of Indiana,
- 2.) I am familiar with the plans and specifications for the above referenced subdivision,
- 3.) I have personally observed and supervised the completion of the Drainage Facilities for the above referenced subdivision, and
- 4.) To the best of my knowledge, information and belief, the Drainage Facilities within the subdivision has been installed and completed in conformity with all plans and specifications.

Signature: *Allan H. Weihe* Date: 11/16/95
 Type or Printed Name: Allan H. Weihe
 Business Address: 10505 N. College Ave.
Indianapolis, Indiana 46280
 Telephone: (317) 846-6611

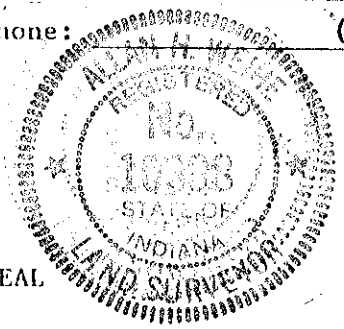

INDIANA REGISTRATION NUMBER
IN.#10398

FILED

NOV 20 1995

HAMILTON COUNTY BOARD OF SURVEYORS

SECRETARY



SURVEYOR'S OFFICE
Hamilton County

Kenton C. Ward, Surveyor

Phone (317) 776-8495

Fax (317) 776-9628

Suite 146

One Hamilton County Square

Noblesville, Indiana 46060-2230

To: Hamilton County Drainage Board

Re: **Anna Kendall Drain - E.M. Osborn Arm
Relocation**

Attached are as-builts, certificate of completion & compliance, and other information for **E.M. Osborn Relocation**. An inspection of the drainage facilities for this section has been made and the facilities were found to be complete and acceptable.

During construction, changes were made to the drain which will alter the plans submitted with my report for this drain dated August 28, 1995. The changes are as follows:

Existing Manhole to Manhole 5 consists of 12" RCP which was lengthened from 370' feet to 371' feet and the 45 degree elbow consists of 18' of 12" RCP which was changed from 20' of CFT. Manhole 5 to Manhole 4 consists of 12" RCP at 560'. The Original plan called for 580' feet of concrete field tile. Manhole 4 to Manhole 3 consists of 12" RCP which was lengthened from 720' feet to 739' feet. Manhole 3 to Manhole 2 consists of 12" RCP which was lengthened from 255' feet to 256' feet. Manhole 2 to Manhole 1 consists of 12" CFT which was lengthened from 310' feet to 311' feet. The total length of the new drain remains at 2255 feet. There was 1890 feet of original drain vacated. This relocation added a total of **365 feet** to the drains length.

The non-enforcement was approved by the Board at its meeting on September 25, 1995.

The cost of the relocation was paid for by Fabcon, Inc.

I recommend the Board approve the drains construction as complete and acceptable.



Sincerely,

Kenton C. Ward,
Hamilton County Surveyor

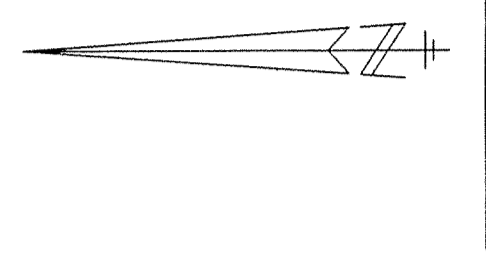
KCW/slm

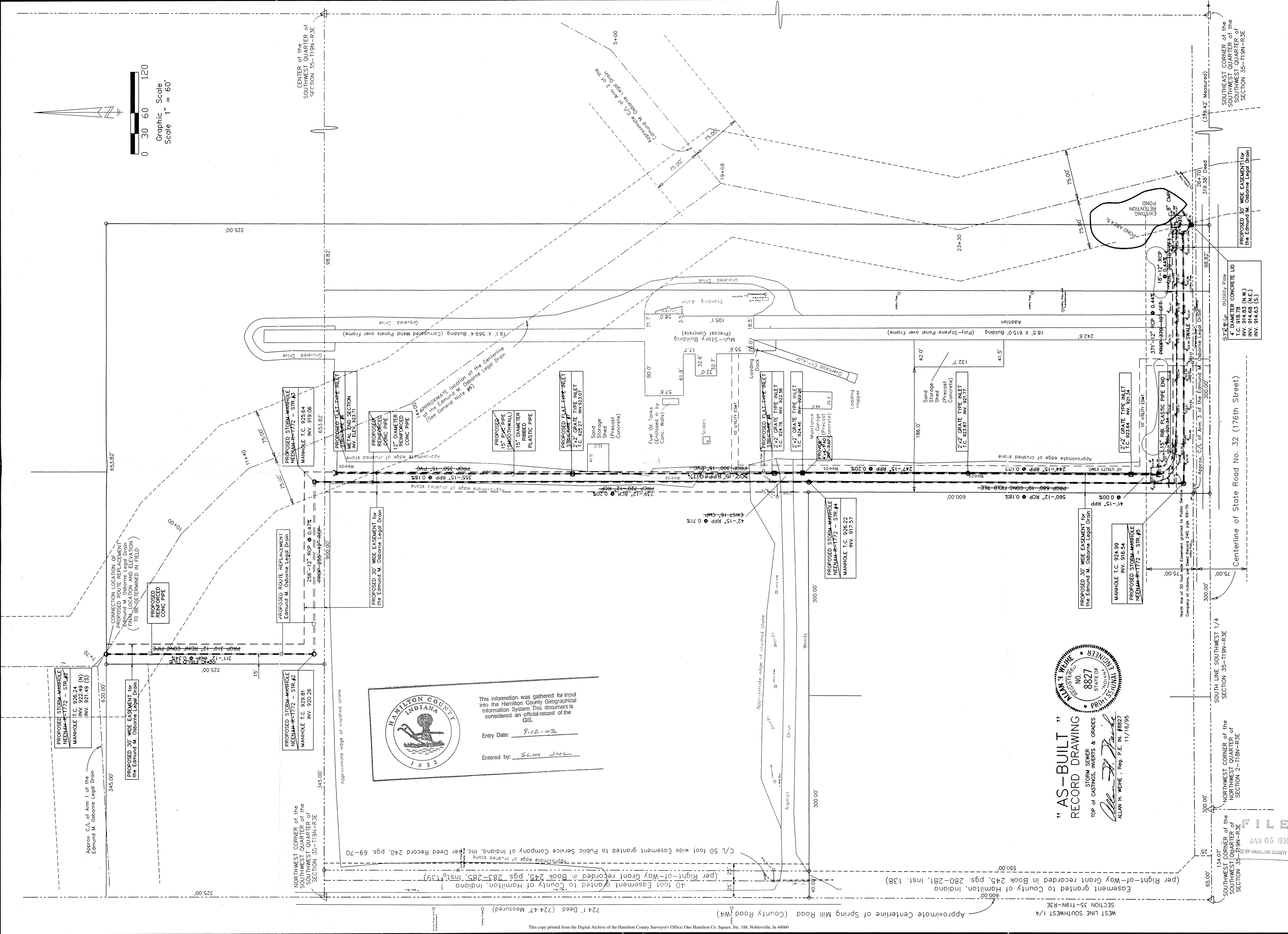

Graphic Scale
Scale 1" = 60'

This information was gathered for input into the Hamilton County Geographical Information System. This document is considered an official record of the GIS.

Entry Date: 9-12-03

Entered by: SLM JNL

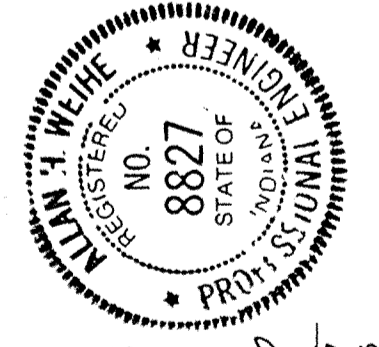

"AS-BUILT"
RECORD DRAWING
TOP OF CASTINGS, INVERTS & GRADES
ALLAN H. WEIHE, Reg. P.E. IN. #8827
11/16/95

1 AB

2

Sheet

Prepared for: FABCON, INCORPORATED
6111 WEST HWY 13 SAVAGE, MN. 55378-1298
OSBORNE REROUTE, STORM SEWER AS-BUILT INFORMATION

Revisions:

Date	By	Job Number
1-24-95	L.S.	95-312
11-10-95	MCX	
1/4/95	MCX	

Drawn By: MCX
Checked By: SAN
Date: Aug. 28 1995

LAND SURVEYORS
CIVIL ENGINEERS

WEIHE ENGINEERS, INC.
10605 NORTH COLLEGE AVENUE
INDIANAPOLIS, INDIANA 46290
(317) 846-6611
ALLAN H. WEIHE, P.E., L.S.
President

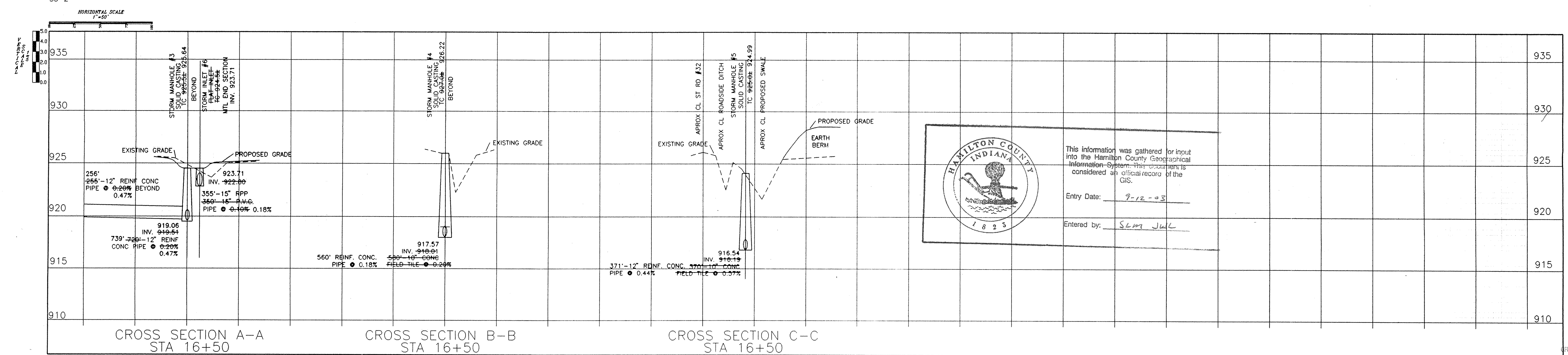
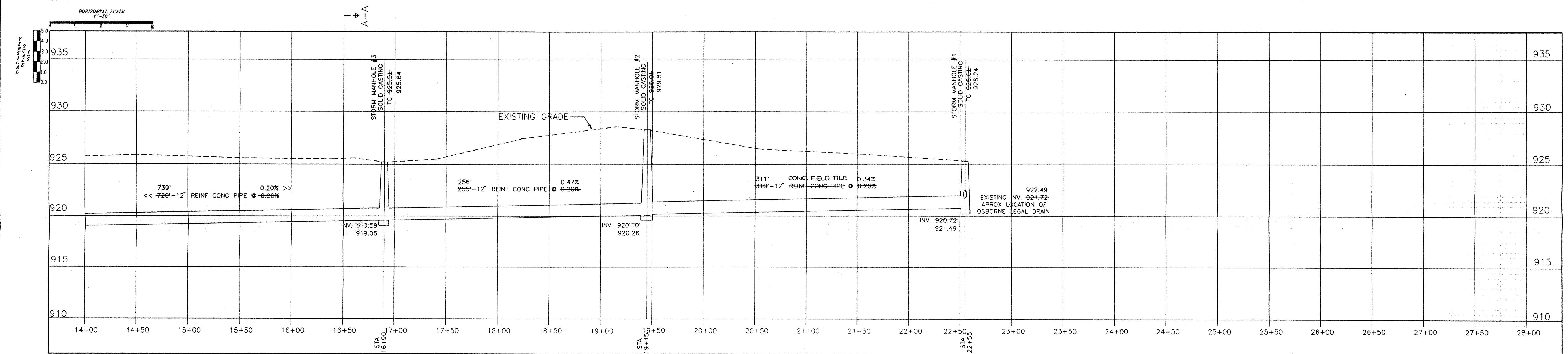
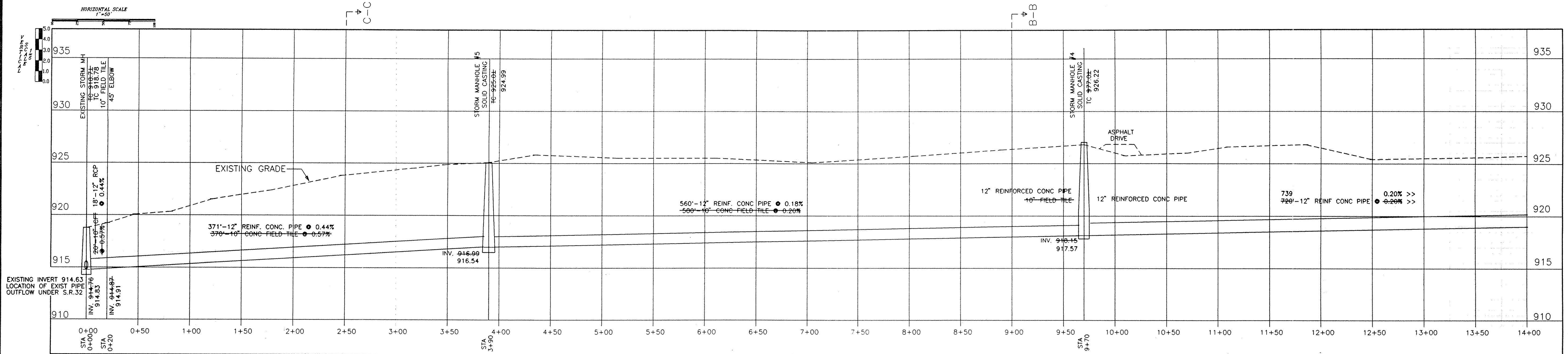

HAMILTON COUNTY INDIANA
 This information was gathered for input into the Hamilton County Geographical Information System. This document is considered an official record of the GIS.
 Entry Date: 7-12-95
 Entered by: SLM JML

FILED
 JAN 05 1996
 OFFICE OF HAMILTON COUNTY SURVEYOR

"AS-BUILT" RECORD DRAWING
 STORM SEWER
 TOP OF CASTINGS, INVERTS & GRADES
 Allan H. Weihe
 ALLAN H. WEIHE, Reg. P.E. IN. #8827
 11/16/95

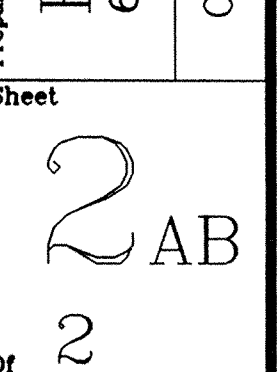

WEIHE ENGINEERS, INC.
 ALLAN H. WEIHE, P.E., L.S., President
 10505 NORTH COLLEGE AVENUE
 INDIANAPOLIS, INDIANA 46260
 (317) 940-0811

Job Number: 95-312
 Drawn By: MCK
 Checked By: MCK
 Date: 7/14/95
 Scale: AS SHOWN
 Date: 7/14/95
 Scale: AS SHOWN

FABCON, INCORPORATED
 6111 WEST HWY 13 SAVAGE, MN. 55378-1298
 OSBORNE LEGAL DRAIN REROUTE : PROFILE AS-BUILT INFORMATION